

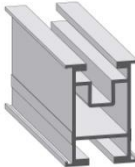

DELIVERY PROGRAM FOR
ON ROOF SYSTEM 2.1

PROFILE

<p>Article-No.: 16412 Product-No.: 802100</p> 	<p>Mounting profile 45</p> <p>Outside dimensions: 32 x 45 x 6000 mm 1x Mounting channel for threaded plate M8 1x Mounting channel for hammer head screw M8 or M10</p>	<p>Drawing number: 802100 A</p> <p>Material: EN AW 6063 / T66</p> <p>Weight: 0,816 kg/m</p> <p>Wx, Wy: 3.007 mm³, 1.972 mm³</p>
<p>Article-No.: 16609 Product-No.: 802190</p> 	<p>Mounting profile 45 black</p> <p>Surface black anodized Outside dimensions: 32 x 45 x 6000 mm 1x Mounting channel for threaded plate M8 1x Mounting channel for hammer head screw M8 or M10</p>	<p>Drawing number: 802190 A</p> <p>Material: EN AW 6063 / T66</p> <p>Weight: 0,816 kg/m</p> <p>Wx, Wy: 3.007 mm³, 1.972 mm³</p>
<p>Article-No.: 16414 Product-No.: 802101</p> 	<p>Mounting profile 48</p> <p>Outside dimensions: 35 x 48 x 6000 mm 2x Mounting channel for hammer head screw or threaded plate M8 1x Mounting channel for hammer head screw M8 or M10</p>	<p>Drawing number: 802101 A</p> <p>Material: EN AW 6063 / T66</p> <p>Weight: 1,055 kg/m</p> <p>Wx, Wy: 3.997 mm³, 2.742 mm³</p>
<p>Article-No.: 16439 Product-No.: 802102</p> 	<p>Mounting profile 65</p> <p>Outside dimensions: 40 x 65 x 6000 mm 1x Mounting channel for threaded plate M8 1x Mounting channel for hammer head screw M8 or M10</p>	<p>Drawing number: 802102 A</p> <p>Material: EN AW 6063 / T66</p> <p>Weight: 1,216 kg/m</p> <p>Wx, Wy: 7.795 mm³, 3.922 mm³</p>

Article-No.: 16444
Product-No.: 802103

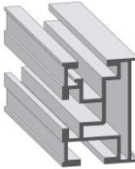
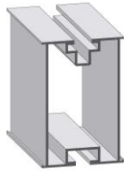

Mounting profile 95

Outside dimensions: 62 x 95 x 6000 mm
1x Mounting channel for threaded plate M8
1x Mounting channel for hammer head screw M8 or M10

Drawing number: 800103 A

Material: EN AW 6063 / T66

Weight: 1,655 kg/m

Wx, Wy: 16.700 mm³, 8.930 mm³

PROFILE CONNECTOR

Article-No.: 16416
Product-No.: 802150



Profile connector 45

Outside dimensions: 22,3 x 22 x 270 mm

Drawing number: 802150 A

Material: EN AW 6063 / T66

Article-No.: 16438
Product-No.: 802151

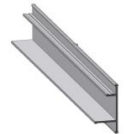

Profile connector 48

Outside dimensions: 20,4 x 42,9 x 270 mm

Drawing number: 802151 A

Material: EN AW 6063 / T66

Article-No.: 16441
Product-No.: 802152

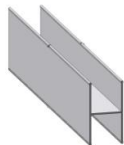

Profile connector 65

Outside dimensions: 30,3 x 58,3 x 400 mm

Drawing number: 802152 A

Material: EN AW 6063 / T66

Article-No.: 16446
Product-No.: 802153

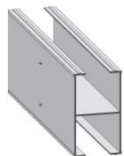

Profile connector 95

Outside dimensions: 51,1 x 91,3 x 400 mm

Drawing number: 802153 A

Material: EN AW 6063 / T66

CROSS CONNECTOR

Article-No.: 16417
Product-No.: 802200

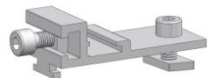

Cross connector 45/48/65

For mounting profile 45, 48 und 65
Incl. socket screw M8 x 30 with square nut M8
Incl. socket screw M8 x 16 with threaded plate type 28 x 15 and Tuflock

Drawing number: 802200 A

Material: EN AW 6063 / T6; A2-70

CLAMPS FOR FRAMED MODULES - PREMOUNTED

Article-No.: see text
Product-No.: see text



Middle clamp premounted H=34-50 mm

L=50 mm incl. opening-function

Frame height:	Product-No.:	Article-No.:
34-38	802301-34V	15782
40-43	802301-40V	15783
45-46	802301-45V	15784
47-50	802301-50V	15785

For mounting profile with threaded plate canal M8

Drawing number: 800301-34V A – 800301-50V A

Material: EN AW 6060 / T5; A2-70

Article-No.: see text
Product-No.: see text



End clamp premounted H=34-50 mm

L=50 mm incl. opening-function

Frame height:	Product-No.:	Article-No.:
31	802304-31V	16481
34	802304-34V	15786
35	802304-35V	15787
36	802304-36V	15789
38	802304-38V	15790
40	802304-40V	15791
42	802304-42V	15792
43	802304-43V	15793
45	802304-45V	15795
46	802304-46V	15794
50	802304-50V	15797

For mounting profile with threaded plate canal M8

Drawing number: 800304-34V A – 800304-50V A

Material: EN AW 6060 / T5; A2-70

Article-No.: see text
Product-No.: see text



Middle clamp premounted H=34-50 mm black
L=50 mm incl. opening-function; Surface black anodized

Frame height:	Product-No.:	Article-No.:
34-38	802391-34V	16603
40-43	802391-40V	16615
45-46	802391-45V	16618
47-50	802391-50V	16619

For mounting profile with threaded plate canal M8

Drawing number: 800391-34V A – 800391-50VA

Material: EN AW 6060 / T5; A2-70

Article-No.: see text
Product-No.: see text



End clamp premounted H=34-50 mm black
L=50 mm incl. opening-function; Surface black anodized

Frame height:	Product-No.:	Article-No.:
35	802394-35V	16602
40	802394-40V	16614
45	802394-45V	16620
50	802394-50V	16621

For mounting profile with threaded plate canal M8

Drawing number: 800394-34V A – 800394-50V A

Material: EN AW 6060 / T5; A2-70

Further lengths, surfaces, laminate strengths, ID as well as individual preassembled sets or individual packed units on request

ROOF HOOKS

Article-No.: 16418
Product-No.: 802400



Roof hooks Standard 35 x 6 for fast mounting

Heavy duty design B, T-piece
Plate: 150 x 50 x 5 shaft: 35 x 6

Drawing number: 802400 A

Material: Stainless steel 1.4301; EN AW 6063/T66

Thrust (kN): 1,1

Tensile force(kN): 1,1

Article-No.: 16419
Product-No.: 802401



Roof hooks DV 30 x 6 for fast mounting

Tripple adjustable
Plate: 140 x 56 x 5 shaft: 30 x 6 supporting angle: 70 x 60 x 5

Drawing number: 802401 A

Material: Stainless steel 1.4301; EN AW 6063/T66

Thrust (kN): 0,8

Tensile force(kN): 0,8

Article-No.: 16423
Product-No.: 802402



Roof hooks SL 35 x 8 for fast mounting

Plate: 150 x 80 x 5 shaft: 35 x 8



Drawing number: 802402 A

Material: Stainless steel 1.4016; EN AW 6063/T66



Thrust (kN): 2,16

Tensile force (kN): 1,44

HANGER BOLT

<p>Article-No.: 16424 Product-No.: 802403</p> 	<p>Hanger bolt M10 x 200 for fast mounting</p> <p>M10 x 200, preassembled with 3 locking nuts and seal with mounting plate for fast mounting</p> <p>Thrust (kN): 1,96 Tensile force(kN): 1,96</p> <p>Note: Minimum thread 50 mm!</p>	<p>Drawing number: 802403 A</p> <p>Material: A2-70; EN AW 6063 / T66; EPDM</p>
<p>Article-No.: 16425 Product-No.: 802404</p> 	<p>Hanger bolt M12 x 300 for fast mounting</p> <p>M12 x 300, preassembled with 3 with 3 locking nuts and seal with mounting plate for fast mounting</p> <p>Thrust (kN): 2,4 Tensile force(kN): 2,4</p> <p>Note: Minimum thread 50 mm!</p>	<p>Drawing number: 802404 A</p> <p>Material: A2-70; EN AW 6063 / T66; EPDM</p>

ACCESSORIES

<p>Article-No.: 16596 Product-No.: 800601</p> 	<p>Shutter 45</p> <p>Shutter for mounting profile 45 (802100)</p>	<p>Drawing number: MT0030246#1</p> <p>Material: PVC</p>												
<p>Article-No.: see text Product-No.: see text</p> 	<p>Flat head screw</p> <table border="1"> <thead> <tr> <th>Dimension:</th> <th>Product-No.:</th> <th>Article-No.:</th> </tr> </thead> <tbody> <tr> <td>8 x 80</td> <td>800643</td> <td>15191</td> </tr> <tr> <td>8 x 100</td> <td>800665</td> <td>16598</td> </tr> <tr> <td>8 x 120</td> <td>800664</td> <td>16531</td> </tr> </tbody> </table>	Dimension:	Product-No.:	Article-No.:	8 x 80	800643	15191	8 x 100	800665	16598	8 x 120	800664	16531	<p>Drawing number: 800643 A</p> <p>Material: A2-70</p>
Dimension:	Product-No.:	Article-No.:												
8 x 80	800643	15191												
8 x 100	800665	16598												
8 x 120	800664	16531												

SEEHAM AUSTRIA

Alumero
Systematic Solutions GmbH
Sonnenweg 1-2
5164 Seeham - Österreich

SINGEN GERMANY

Alumero
Lean Extrusions GmbH & Co. KG
Carl-Benz-Str. 35
78224 Singen - Deutschland

CHORZOW POLAND

Alumero
Metal Components Sp. z., o.o
Ul. Kluczborska 29
41-508 Chorzów - Polska

HELMOND NETHERLANDS

Alumero
Finex Extrusions B.V.
Duizeldonksestraat 20
5705 CA Helmond - Nederland

SL. BISTRICA SLOWENIA

Alumero
Metal Components d.o.o.
Kolodvorska 39
2310 Sl. Bistrica - Slovenija

WWW.ALUMERO.AT

CONTACT HEADQUARTER

Alumero Systematic Solutions GmbH
Sonnenweg 1-2
5164 Seeham - Austria
T +43 6217 / 68 41-0
F +43 6217 / 68 41-41
alumero@alumero.at
www.alumero.at

I'M ALWAYS HERE
WHEN YOU NEED ME.

